

# HARVEST MOON TRAIL CONNECTION & UPGRADES

WOLFVILLE, NOVA SCOTIA

REVISION 1, APR. 11, 2025, ISSUED FOR REVIEW

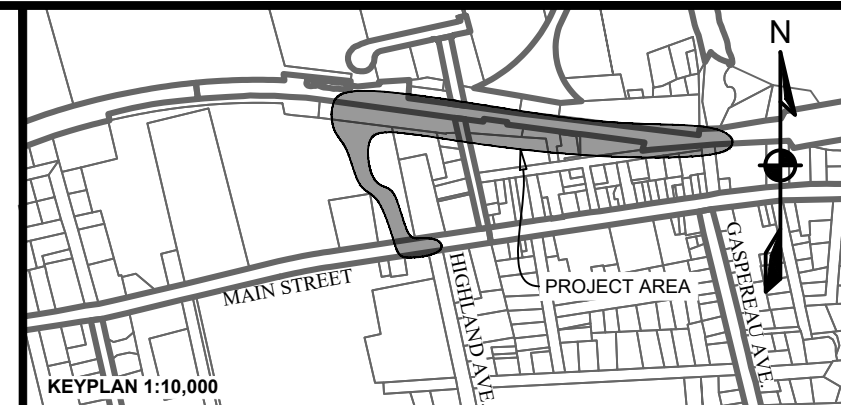

## LEGEND

EXISTING		PROPOSED
---	VERTICAL PROFILE	---
---	APPROXIMATE 1 IN 100 YEAR FLOOD LIMIT	---
---	CENTERLINE	---
---	EASEMENT	---
---	DITCH CENTERLINE	---
---	ROCK-LINED DITCH	---
---	CULVERT	---
---	WATERCOURSE	---
---	WETLAND BOUNDARY	---
---	20 m BUFFER	---
---	GUARDRAIL	---
---	TOP OF SLOPE	---
---	BOTTOM OF SLOPE	---
---	OVERHEAD LINE	---
---	FENCELINE	---
---	EXISTING PROPOSED	---
---	PRECAST HEADWALL	---
---	STREET SIGN	---
---	SURFACE FLOW	---
---	UTILITY POLE w/ GUY WIRE	---

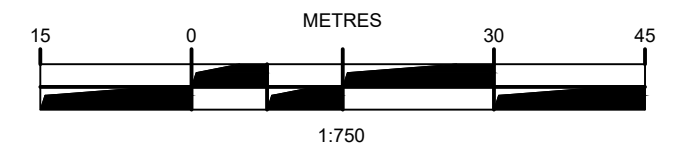

2	DRAFT	ISSUED FOR TENDER
1	APR. 11, 2025	ISSUED FOR REVIEW
ISSUE	DATE	DESCRIPTION

CONSULTANT

**DESIGNPOINT**  
engineering • surveying • solutions

902.832.5597

designpoint.ca

CLIENT



PROJECT DESCRIPTION

**HARVEST MOON TRAIL  
CONNECTION & UPGRADES**

WOLFVILLE, NOVA SCOTIA

SHEET DESCRIPTION

**SITE PLAN**

Drawn J. BENEDICT	Engineer G. WOODFORD	Project No. 23-410	Drawing No. <b>C-01</b>
Scale 1:750	Filename 23-410_Base.dwg		1 of 10

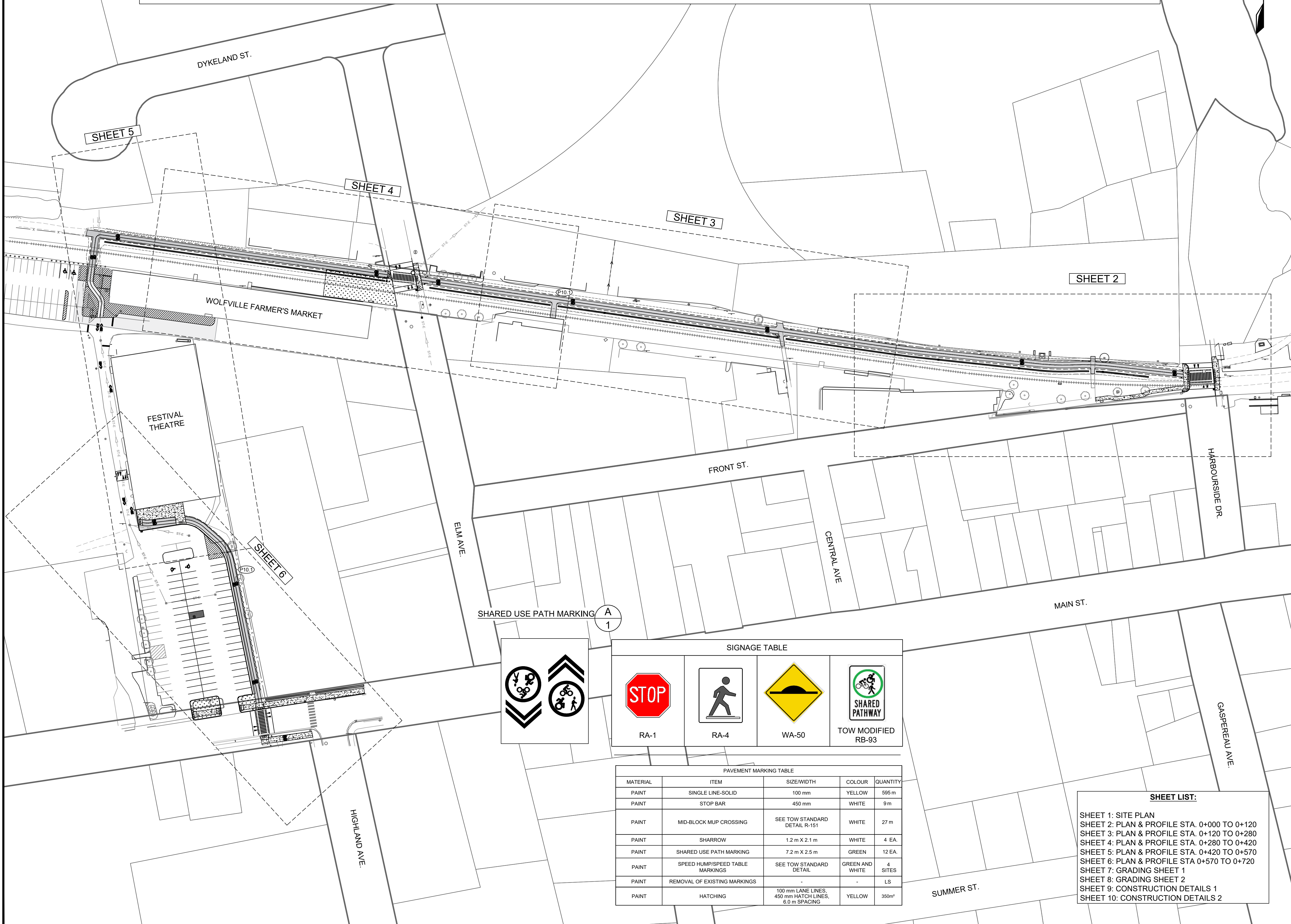



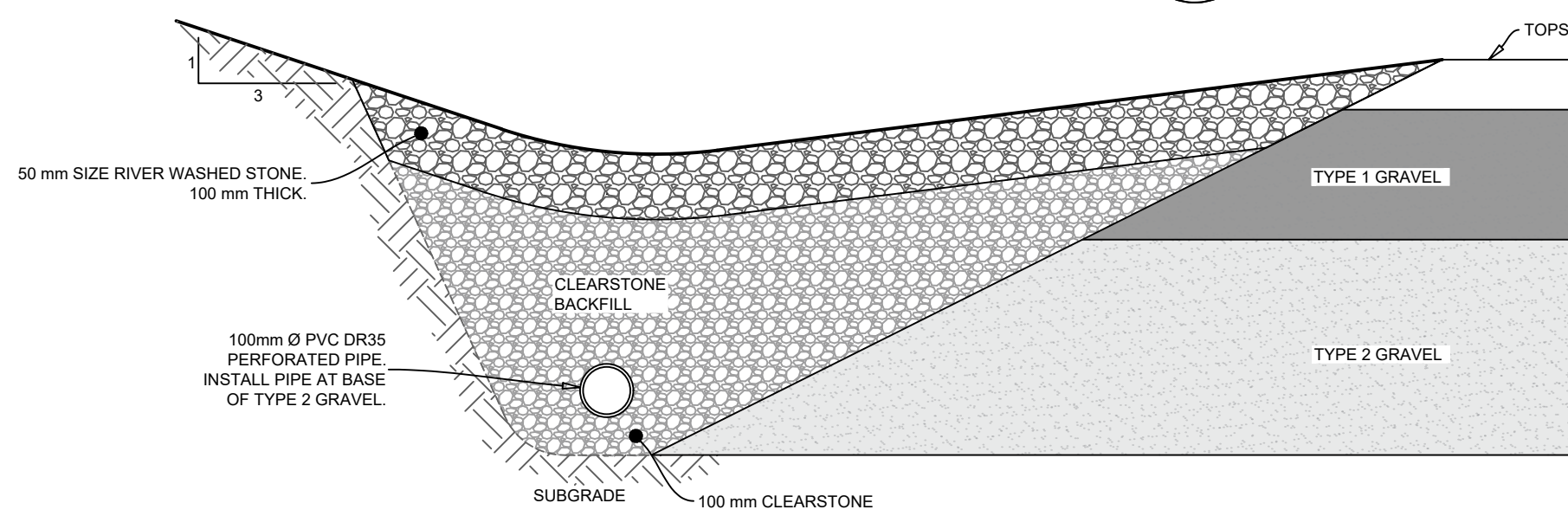
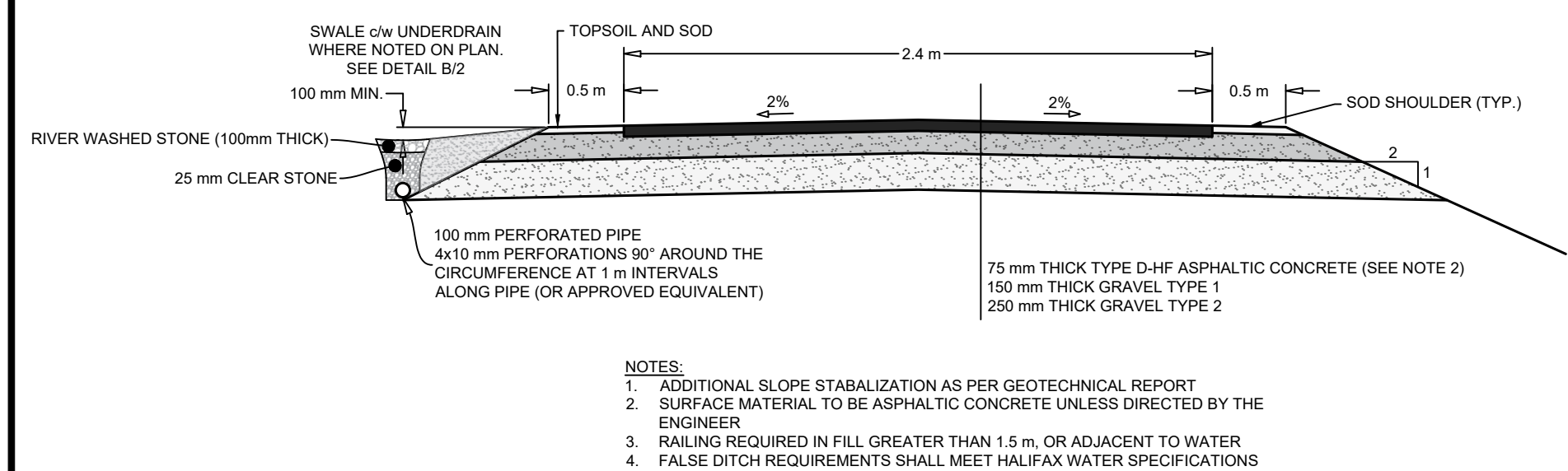
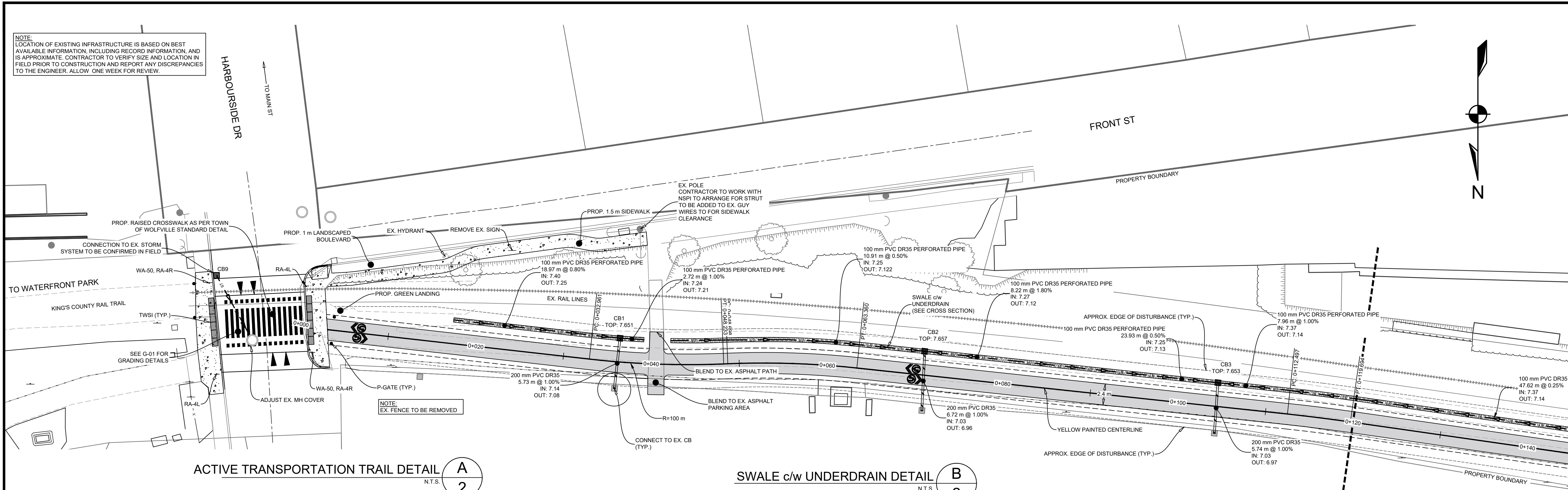

### HARVEST MOON TRAIL CENTRELINE PROFILE

SCALE: 1:250H, 1:25V

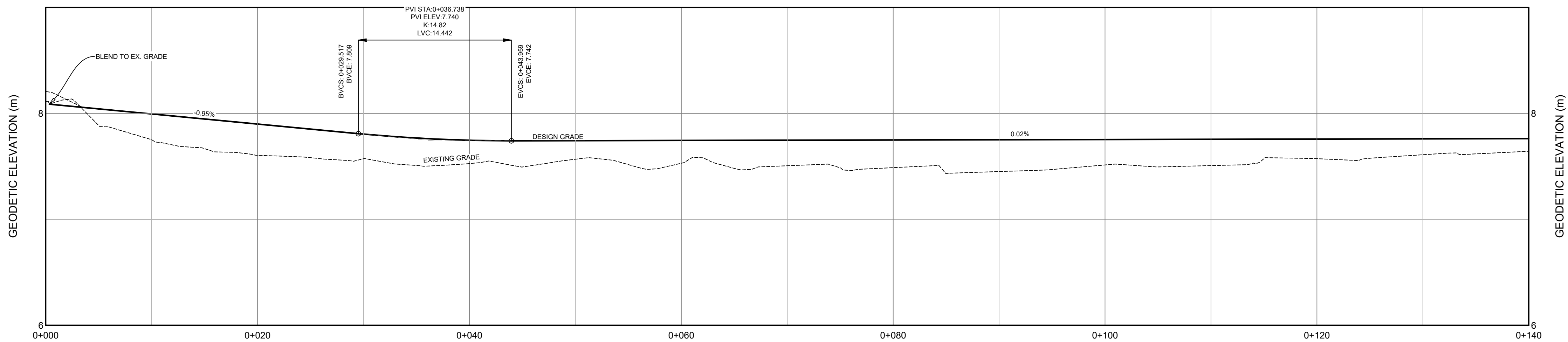

### CROSS SECTIONS

SCALE: 1:250H, 1:250V

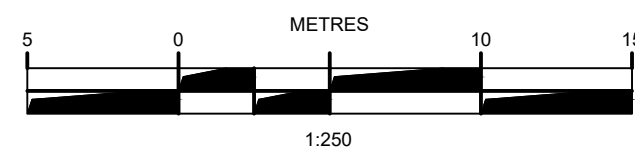
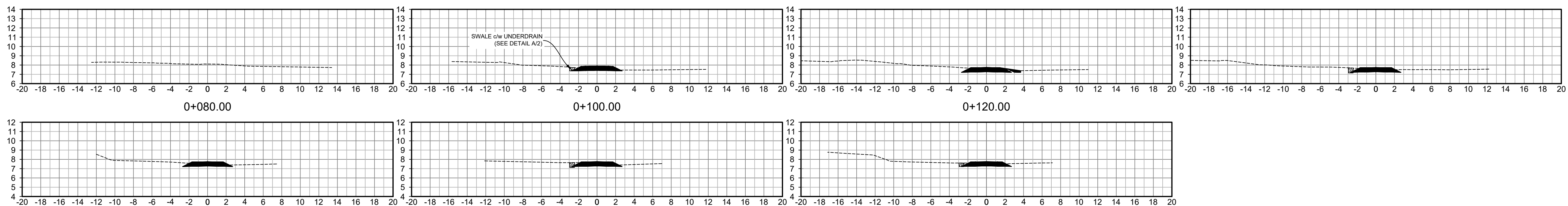

2	DRAFT	ISSUED FOR TENDER
1	APR. 11, 2025	ISSUED FOR REVIEW
ISSUE	DATE	DESCRIPTION

CONSULTANT

**DESIGNPOINT**  
engineering • surveying • solutions

902.832.5597 designpoint.ca

CLIENT



PROJECT DESCRIPTION

**HARVEST MOON TRAIL  
CONNECTION & UPGRADES**

WOLFVILLE, NOVA SCOTIA

SHEET DESCRIPTION

**PLAN & PROFILE**  
STA. 0+000 TO 0+120

Drawn J. BENEDICT	Engineer G. WOODFORD	Project No. 23-410	Drawing No. C-02
Scale 1:250 H, 1:25 V	Filename 23-410_Base.dwg		2 of 10



**NOTE:**  
LOCATION OF EXISTING INFRASTRUCTURE IS BASED ON BEST AVAILABLE INFORMATION, INCLUDING RECORD INFORMATION, AND IS APPROXIMATE. CONTRACTOR TO VERIFY SIZE AND LOCATION IN FIELD PRIOR TO CONSTRUCTION AND REPORT ANY DISCREPANCIES TO THE ENGINEER. ALLOW ONE WEEK FOR REVIEW.

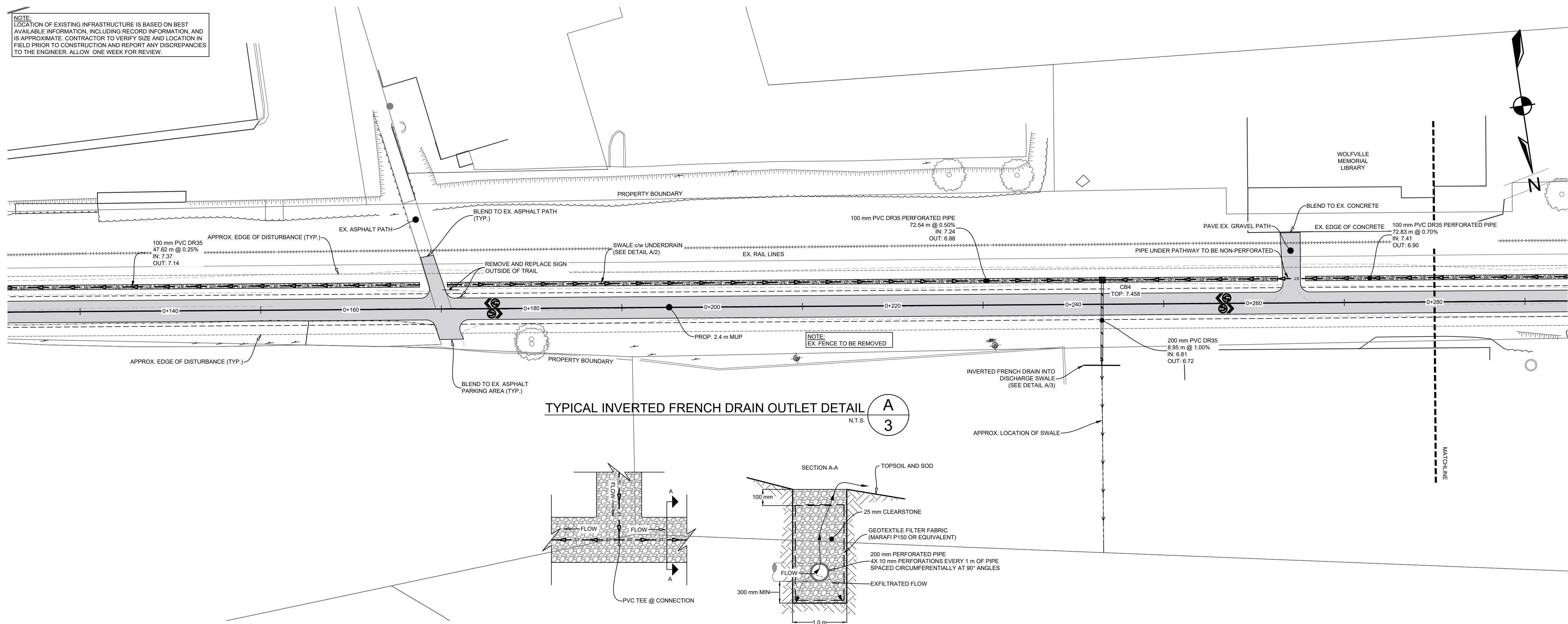



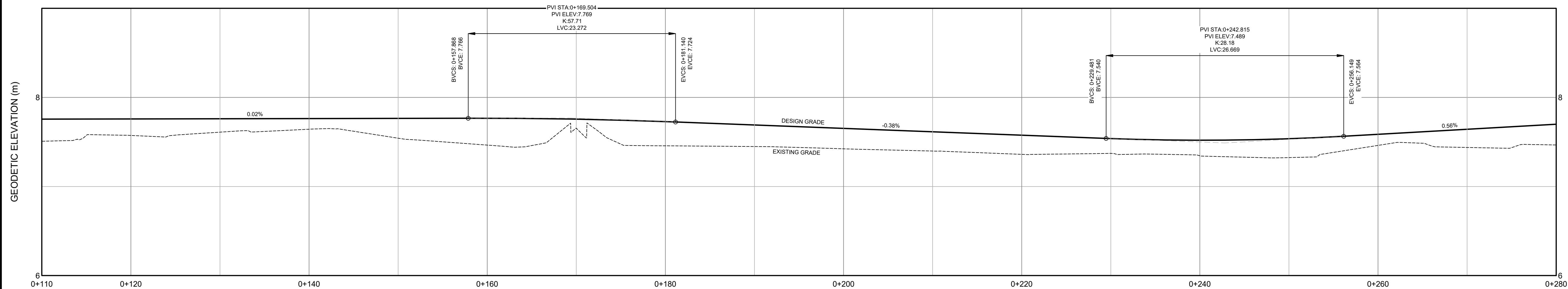



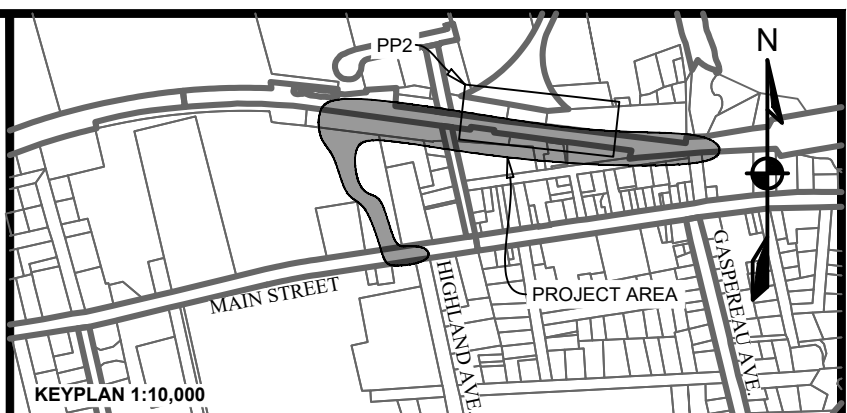
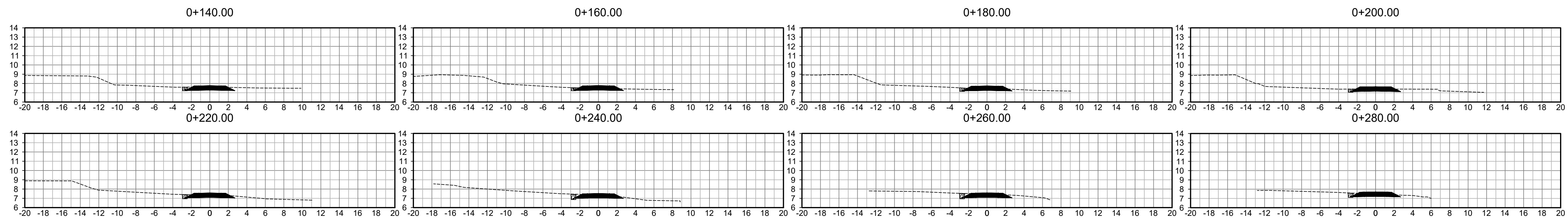



















## HARVEST MOON TRAIL CENTRELINE PROFILE



## CROSS SECTIONS



## LEGEND

EXISTING		VERTICAL PROFILE	PROPOSED
-----		APPROXIMATE 1 IN 100 YEAR FLOOD LIMIT	----- 100-YR
		EASEMENT	WA WA WA
WA-E		WATER PIPE	WA WA WA
SA-E		SANITARY PIPE	SA SA SA
ST-E		STORM PIPE	ST ST ST
+++++		RAILROAD	+++++
		WATER LATERAL	-----
		SANITARY LATERAL	-----
		STORM LATERAL	-----
		DISTURBANCE AREA	-----
		SIDEWALK	-----
		WALKWAY/T. TRAIL	-----
=====		GUARDRAIL	=====
~~~~~		TOP OF SLOPE	~~~~~
~~~~~		BOTTOM OF SLOPE	~~~~~
x-----x		FENCELINE	x-----x
	EXISTING PROPOSED		EXISTING PROPOSED
CURB CUT/RAMP	 	AIR RELEASE VALVE	 
CURBSTOP	 	WATER VALVE	 
REDUCER	 	HYDRANT	 
PRECAST HEADWALL	 	CATCH-BASIN	  
STREET SIGN	 	UTILITY POLE W/ GUY WIRE	  
STREET TREE	 	GLB	
		URD	

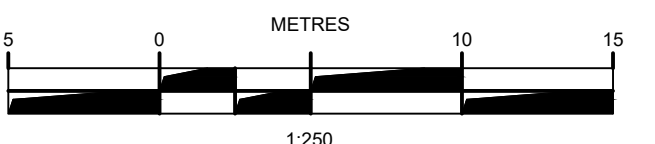

2	DRAFT	ISSUED FOR TENDER
1	APR. 11, 2025	ISSUED FOR REVIEW
ISSUE	DATE	DESCRIPTION
CONSULTANT		

**DESIGNPOINT**  
engineering • surveying • solutions

902.832.5597 designpoint.ca

CLIENT



PROJECT DESCRIPTION	
<p><b>HARVEST MOON TRAIL CONNECTION &amp; UPGRADES</b></p>	

WOLFVILLE, NOVA SCOTIA

---

SHEET DESCRIPTION

PLAN & PROFILE  
STA. 0+120 TO 0+280

Drawn J. BENEDICT	Engineer G. WOODFORD	Project No. 23-410	Drawing No.  <b>C-03</b>  3 OF 10
Scale 1:250 H, 1:25 V	Filename 23-410_Base.dwg		



NOTE:  
LOCATION OF EXISTING INFRASTRUCTURE IS BASED ON BEST AVAILABLE INFORMATION, INCLUDING RECORD INFORMATION, AND IS APPROXIMATE. CONTRACTOR TO VERIFY SIZE AND LOCATION IN FIELD PRIOR TO CONSTRUCTION AND REPORT ANY DISCREPANCIES TO THE ENGINEER. ALLOW ONE WEEK FOR REVIEW.

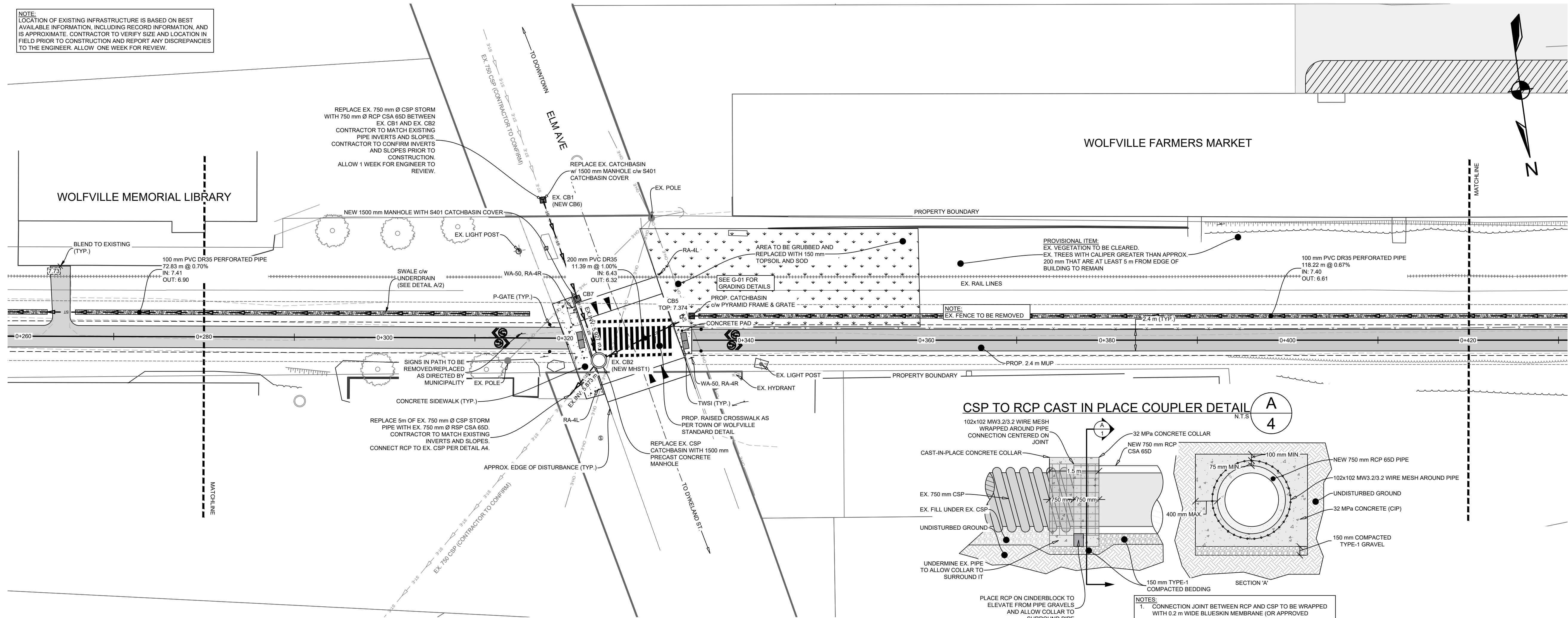

HARVEST MOON TRAIL CENTRELINE PROFILE

SCALE 1:250H 1:25V

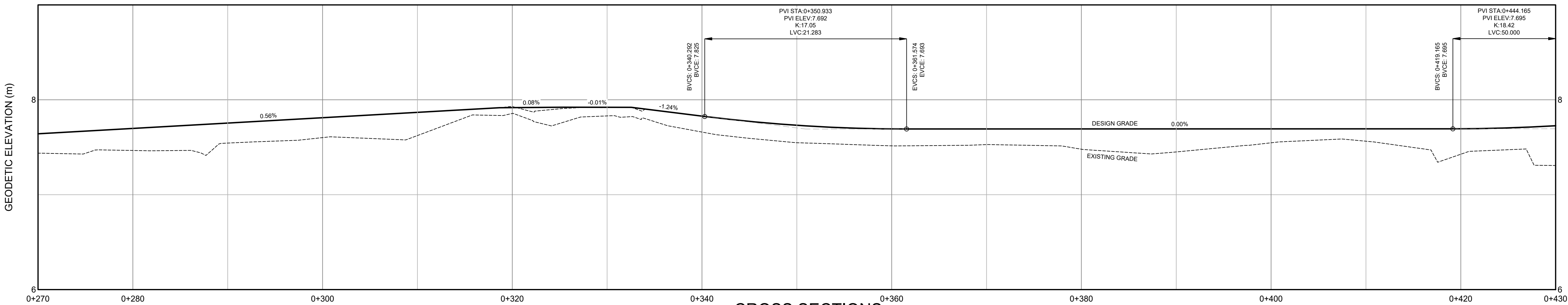

CROSS SECTIONS

SCALE 1:250H 1:250V

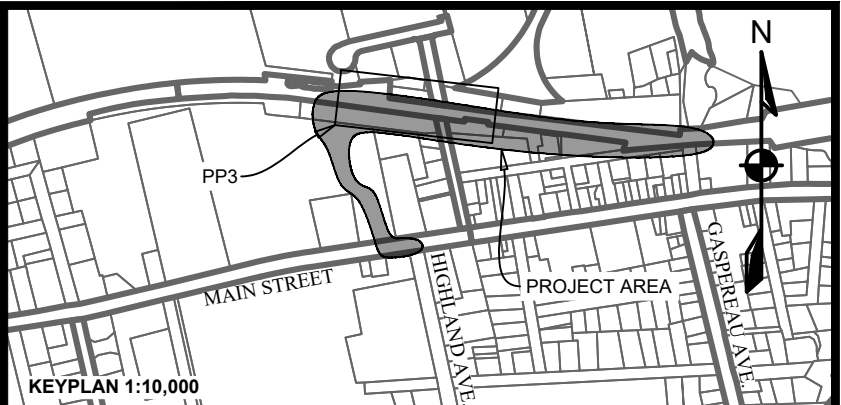
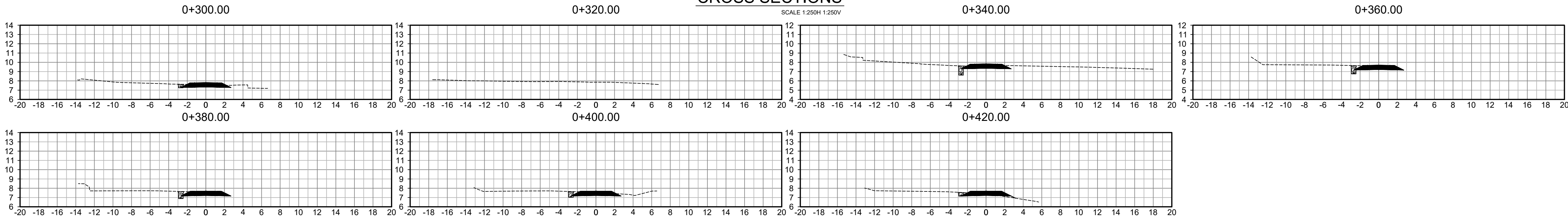

LEGEND

EXISTING	VERTICAL PROFILE	PROPOSED
-----	APPROXIMATE 1 IN 100 YEAR FLOOD LIMIT	-----
-----	EASEMENT	-----
-----	WATER PIPE	-----
-----	SANITARY PIPE	-----
-----	STORM PIPE	-----
-----	NATURAL GAS MAIN	-----
-----	RAILROAD	-----
-----	SANITARY LATERAL	-----
-----	STORM LATERAL	-----
-----	NATURAL GAS LATERAL	-----
-----	DISTURBANCE AREA	-----
-----	WALKWAY/V.T. TRAIL	-----
-----	GUARDRAIL	-----
-----	TOP OF SLOPE	-----
-----	BOTTOM OF SLOPE	-----
-----	FENCELINE	-----
-----	EXISTING PROPOSED	-----
-----	AIR RELEASE VALVE	-----
-----	WATER VALVE	-----
-----	HYDRANT	-----
-----	CATCHBASIN	-----
-----	UTILITY POLE w/ GUY WIRE	-----
-----	GLB	-----
-----	URD	-----

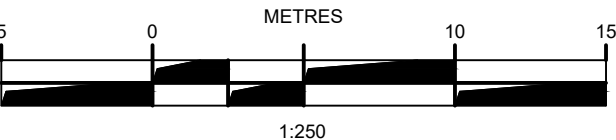

2	DRAFT	ISSUED FOR TENDER
1	APR. 11, 2025	ISSUED FOR REVIEW
ISSUE	DATE	DESCRIPTION

CONSULTANT

**DESIGNPOINT**  
engineering • surveying • solutions

902.832.5597

designpoint.ca

CLIENT



PROJECT DESCRIPTION

**HARVEST MOON TRAIL  
CONNECTION & UPGRADES**

WOLFVILLE, NOVA SCOTIA

SHEET DESCRIPTION

**PLAN & PROFILE  
STA. 0+280 TO 0+420**

Drawn J. BENEDICT	Engineer G. WOODFORD	Project No. 23-410	Drawing No. <b>C-04</b>
Scale 1:250 H, 1:25V	Filename 23-410_Base.dwg		4 of 10



**NOTE:**  
LOCATION OF EXISTING INFRASTRUCTURE IS BASED ON BEST AVAILABLE INFORMATION, INCLUDING RECORD INFORMATION, AND IS APPROXIMATE. CONTRACTOR TO VERIFY SIZE AND LOCATION IN FIELD PRIOR TO CONSTRUCTION AND REPORT ANY DISCREPANCIES TO THE ENGINEER. ALLOW ONE WEEK FOR REVIEW.

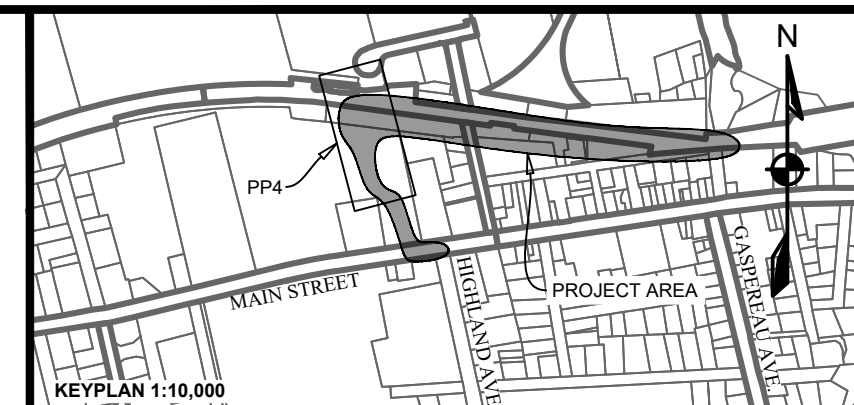
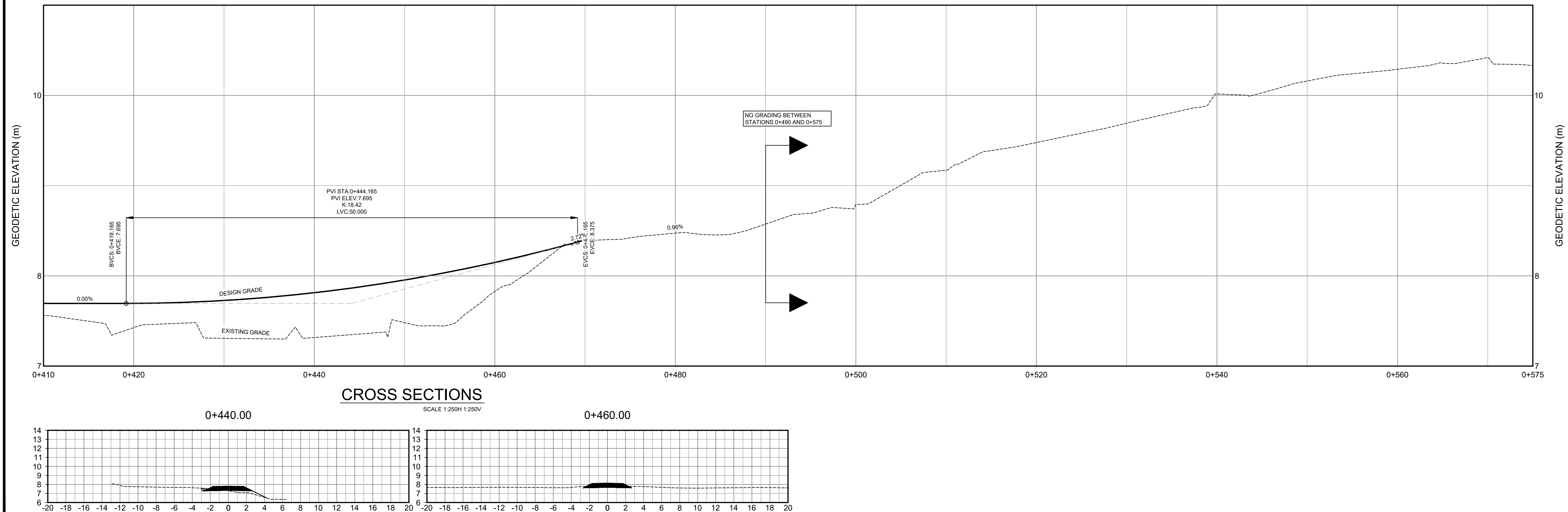
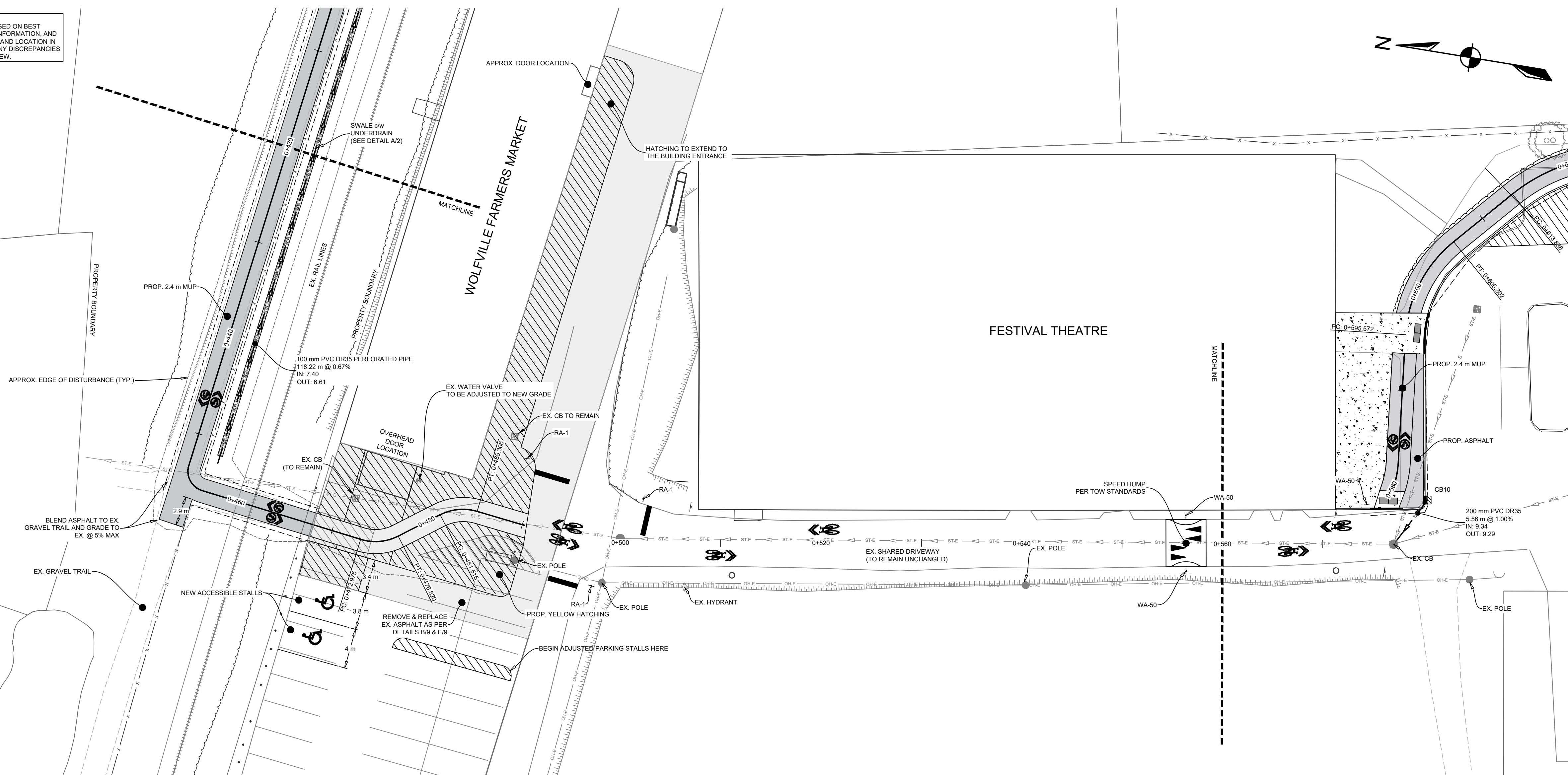

EXISTING		PROPOSED	
		VERTICAL PROFILE	
APPROXIMATE 1 IN 100 YEAR FLOOD LIMIT		100 YR	
EASEMENT			
WA.E		WA	WA
SA.E		SA	SA
ST.E		ST	ST
GAS.E		GAS	
NATURAL GAS MAIN			
RAILROAD			
SANITARY LATERAL			
STORM LATERAL			
NATURAL GAS LATERAL			
DISTURBANCE AREA			
WALKWAY/A.T. TRAIL			
GUARDRAIL			
TOP OF SLOPE			
BOTTOM OF SLOPE			
FENCELINE		X X	
EXISTING PROPOSED		EXISTING PROPOSED	
CURB CUT/RAMP		AIR RELEASE VALVE	
CURBSTOP		WATER VALVE	
REDUCER		HYDRANT	
PRECAST HEADWALL		CATCHBASIN	
STREET SIGN		UTILITY POLE w/ GUY WIRE	
STREET TREE		GLB	
		URD	

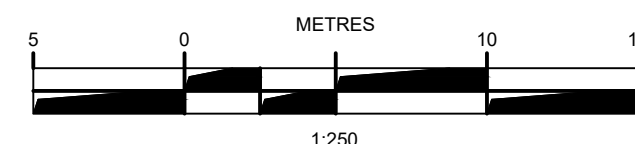

2	DRAFT	ISSUED FOR TENDER
1	APR. 11, 2025	ISSUED FOR REVIEW
ISSUE	DATE	DESCRIPTION
CONSULTANT		

**DESIGNPOINT**  
engineering • surveying • solutions

902.832.5597 designpoint.ca

CLIENT



## PROJECT DESCRIPTION

## HARVEST MOON TRAIL CONNECTION & UPGRADES

WOLFVILLE, NOVA SCOTIA

## SHEET DESCRIPTION

PLAN & PROFILE  
STA. 0+420 TO 0+570

Drawn J. BENEDICT	Engineer G. WOODFORD	Project No. 23-410	Drawing No.  <b>C-05</b>  5 OF 10
Scale 1:250 H, 1:25 V	Filename 23-410_Base.dwg		



NOTE:  
LOCATION OF EXISTING INFRASTRUCTURE IS BASED ON BEST AVAILABLE INFORMATION, INCLUDING RECORD INFORMATION, AND IS APPROXIMATE. CONTRACTOR TO VERIFY SIZE AND LOCATION IN FIELD PRIOR TO CONSTRUCTION AND REPORT ANY DISCREPANCIES TO THE ENGINEER. ALLOW ONE WEEK FOR REVIEW.

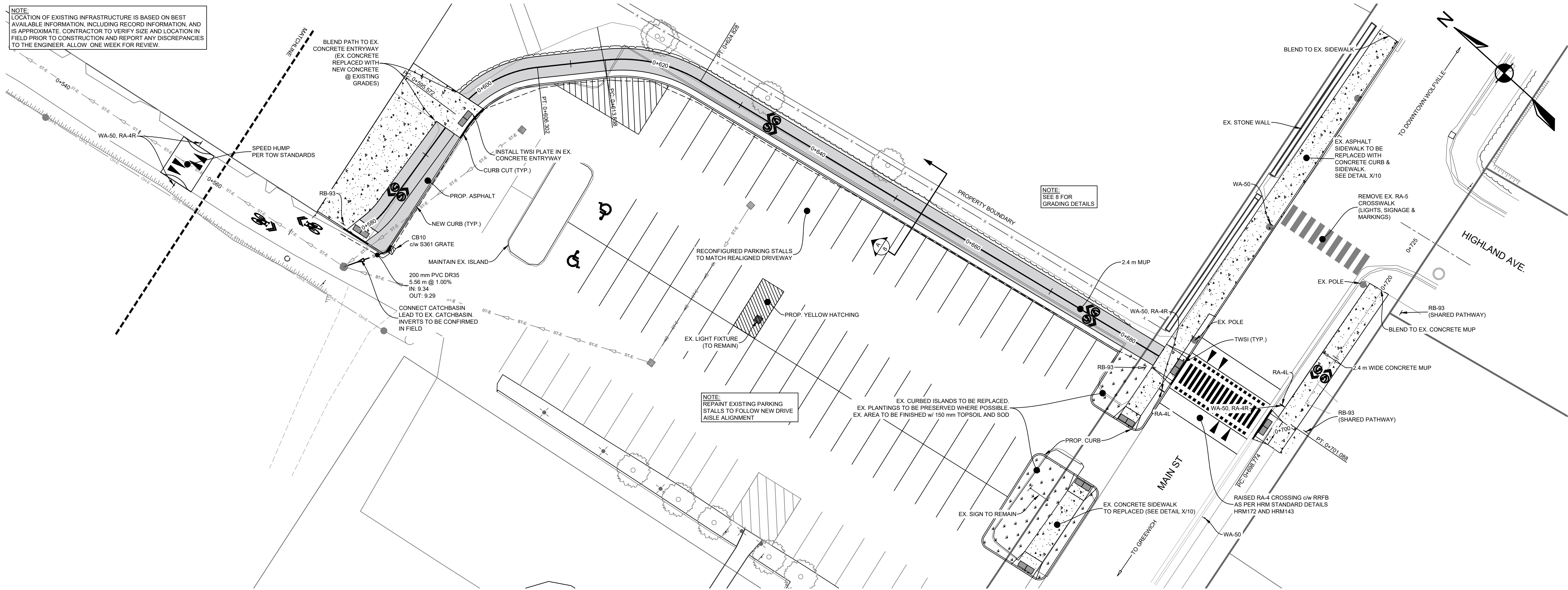

HARVEST MOON TRAIL CENTRELINE PROFILE

SCALE 1:250H 1:25V

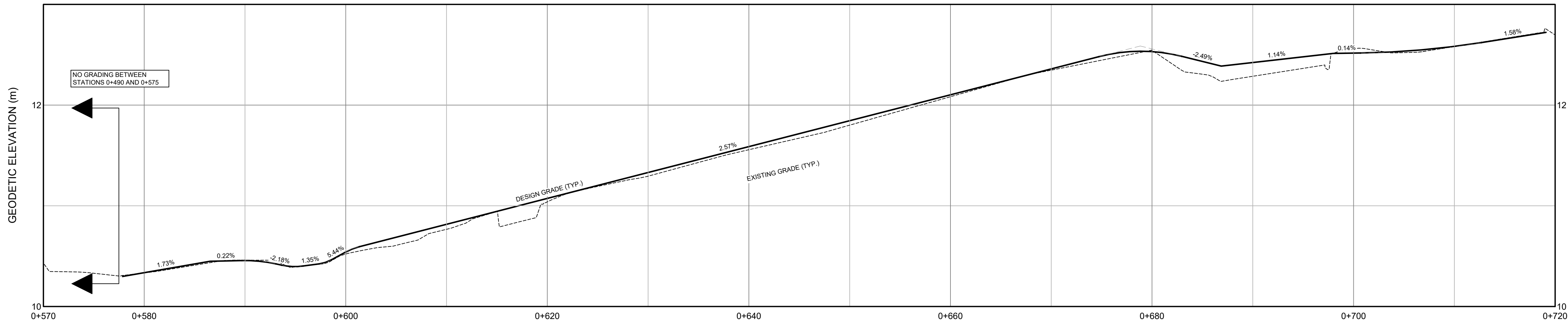

CROSS SECTIONS

SCALE 1:250H 1:250V

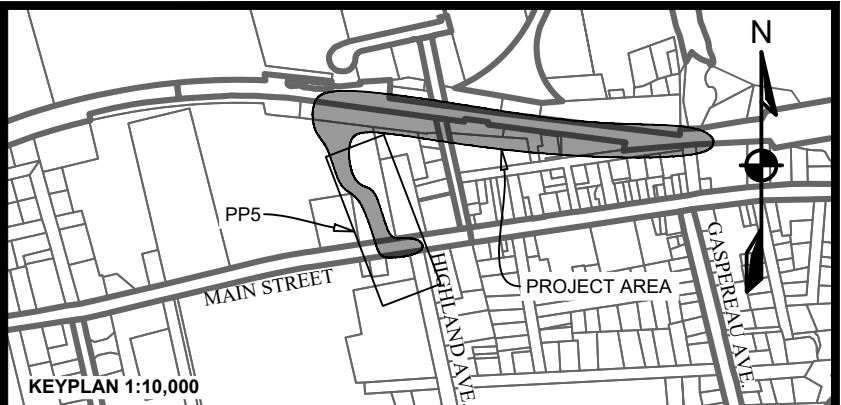
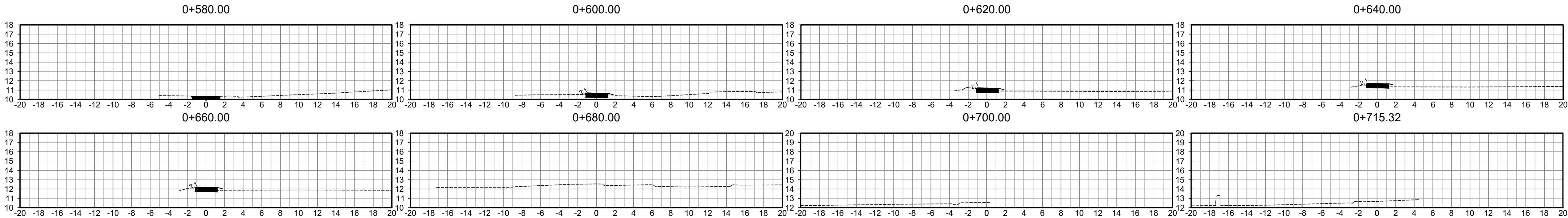

LEGEND

EXISTING	VERTICAL PROFILE	PROPOSED
-----	APPROXIMATE 1 IN 100 YEAR FLOOD LIMIT	-----
-----	EASEMENT	-----
-----	WATER PIPE	-----
-----	SANITARY PIPE	-----
-----	STORM PIPE	-----
-----	NATURAL GAS MAIN	-----
-----	RAILROAD	-----
-----	SANITARY LATERAL	-----
-----	STORM LATERAL	-----
-----	NATURAL GAS LATERAL	-----
-----	DISTURBANCE AREA	-----
-----	WALKWAY/A.T. TRAIL	-----
-----	GUARDRAIL	-----
-----	TOP OF SLOPE	-----
-----	BOTTOM OF SLOPE	-----
-----	FENCELINE	-----
-----	EXISTING PROPOSED	-----
-----	AIR RELEASE VALVE	-----
-----	WATER VALVE	-----
-----	HYDRANT	-----
-----	CATCHBASIN	-----
-----	UTILITY POLE w/ GUY WIRE	-----
-----	GLB	-----
-----	URD	-----

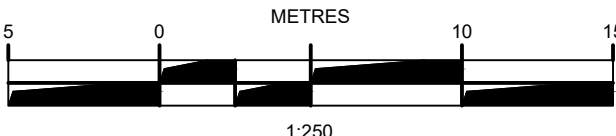

2	DRAFT	ISSUED FOR TENDER
1	APR. 11, 2025	ISSUED FOR REVIEW
ISSUE	DATE	DESCRIPTION

CONSULTANT

**DESIGNPOINT**  
engineering • surveying • solutions

902.832.5597

designpoint.ca

CLIENT



PROJECT DESCRIPTION

**HARVEST MOON TRAIL  
CONNECTION & UPGRADES**

WOLFVILLE, NOVA SCOTIA

SHEET DESCRIPTION



**PLAN & PROFILE  
STA 0+570 TO 0+720**

Drawn J. BENEDICT	Engineer G. WOODFORD	Project No. 23-410	Drawing No. <b>C-06</b>
Scale 1:250 H, 1:25 V	Filename 23-410_Base.dwg		6 of 10





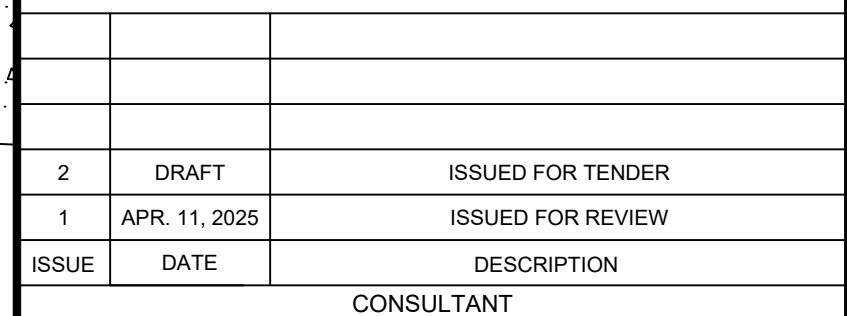
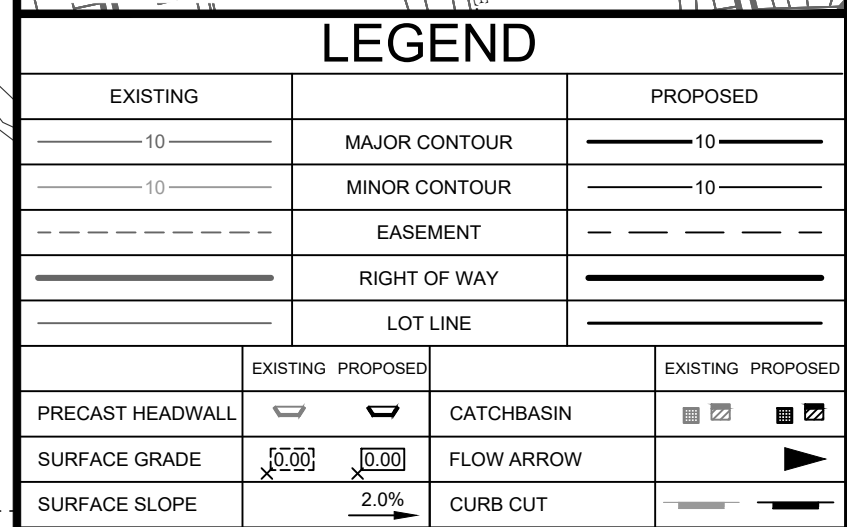
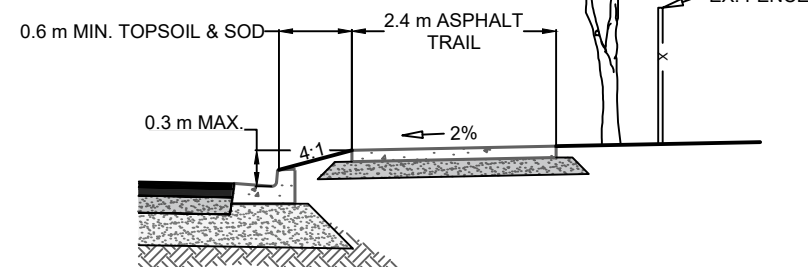

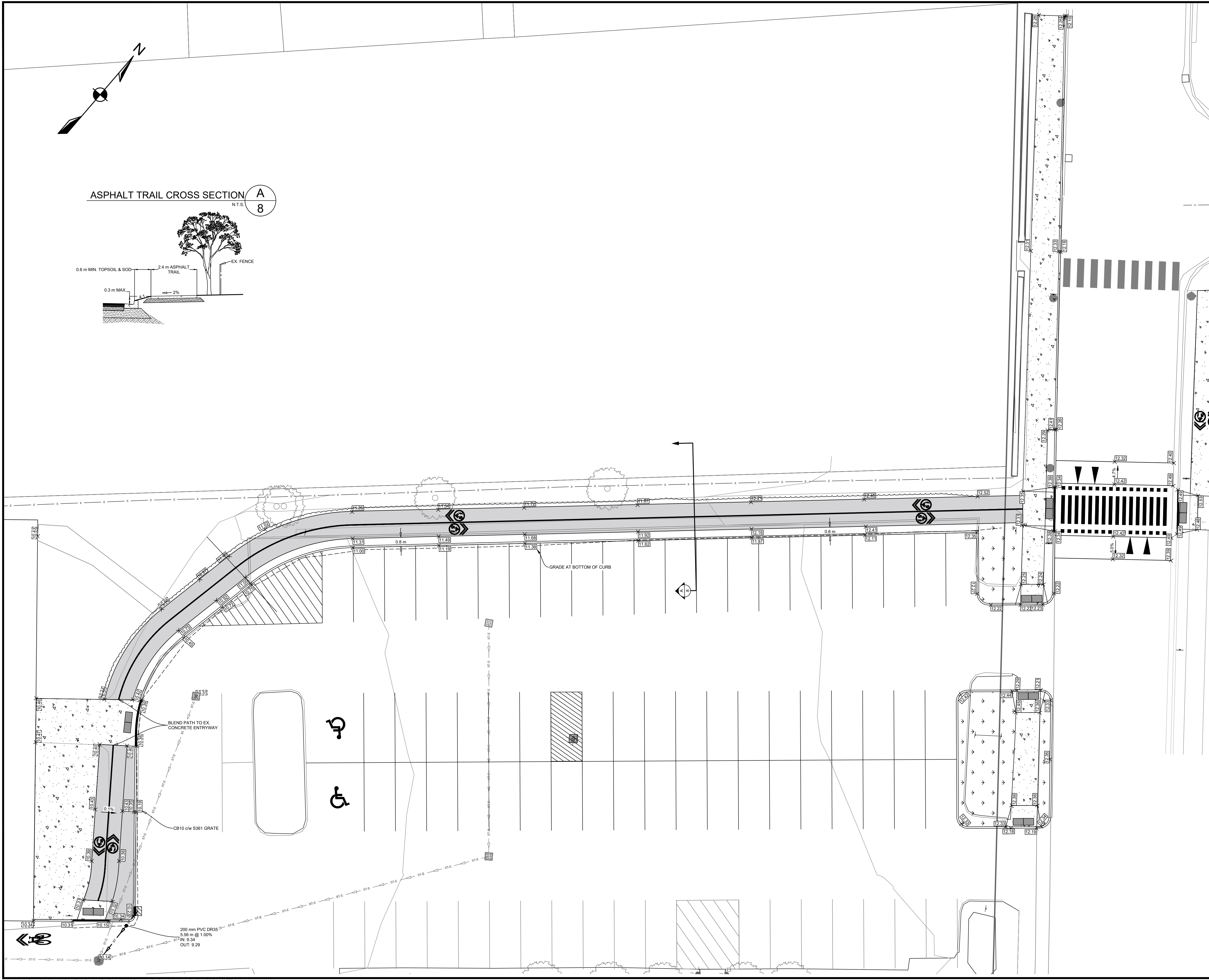

2	DRAFT	ISSUED FOR TENDER
1	APR. 11, 2025	ISSUED FOR REVIEW
ISSUE	DATE	DESCRIPTION
CONSULTANT		

**DESIGNPOINT**  
engineering • surveying • solutions

902.832.5597 designpoint.ca

CLIENT



PROJECT DESCRIPTION	
---------------------	--

## HARVEST MOON TRAIL CONNECTION & UPGRADES

WOLFVILLE, NOVA SCOTIA

## SHEET DESCRIPTION

GRADING SHEET 2

Drawn J. BENEDICT	Engineer G. WOODFORD	Project No. 23-410	Drawing No.  <b>G-02</b>  8 OF 10
Scale 1:150	Filename 23-410_Base.dwg		







A  
10

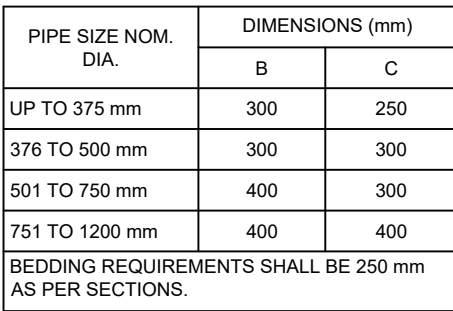

1. SIDES OF TRENCHES TO REQUIREMENTS OF DEPARTMENT OF LABOUR.
2. THE INVERT OF THE STORMWATER SEWER MUST BE AT LEAST 100mm BELOW THE INVERT OF THE WASTEWATER SEWER.
3. A GEOTECHNICAL REPORT BY A P.ENG. MUST BE UNDERTAKEN TO ENSURE STABILITY OF SUBBASE
4. MINIMUM GRAVEL COVER OVER STORMWATER SEWERS IS TO BE 300mm.
5. REFER TO HRM TRENCH REINSTATEMENT DETAILS HRM 59, HRM 60, AND HRM 61.
6. FOR CONCRETE PIPE INSTALLATION, PLEASE REFER TO HWSO - 1442.

B  
10

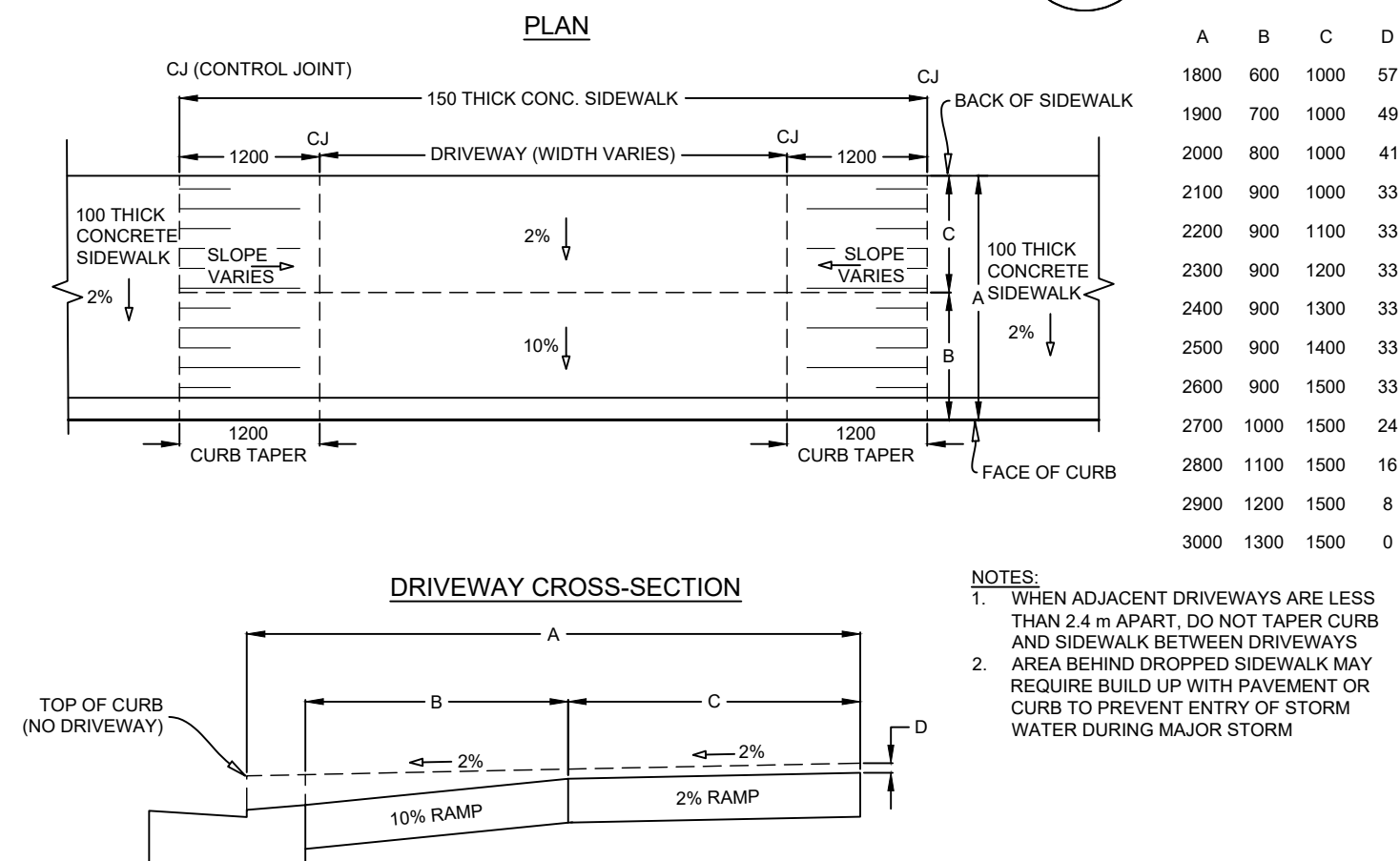

$$\frac{C}{10}$$

